

# Raymond Storage Concepts

## Dock & Door Division

*A Division of Raymond Storage Concepts*



**RAYMOND**  
STORAGE CONCEPTS

# Real Solutions. Every Day.

➤ **Loading docks and commercial doors** have a major impact on warehouse safety and productivity. Proper application, equipment installation, and on-going scheduled maintenance programs can reduce energy consumption, increase worker productivity, and lower the risk of accidents in and around loading dock areas.

Raymond Storage Concepts, Inc. is committed to providing the best dock equipment and commercial door service in the industry. We have a fully dedicated division with industry experienced technicians who specialize in and service all types of loading dock equipment, rolling steel, sectional, and high speed performance doors. We pride ourselves on having the fastest response times, best customer service, and the highest quality of workmanship in the industry.

## **Products & Services:**

- ✓ 24 Hour Emergency Service
- ✓ Dock Levelers / Dock Seals / Dock Shelters
- ✓ Truck Restraints (Hidden Hooks, Wall Mounted, Ground Mounted)
- ✓ Large HVLS Warehouse Ceiling Fans (Up to 24' Diameter)
- ✓ Sectional Doors, Rolling Steel Doors, Fire Doors
- ✓ 4" & 6" Thick Insulated Vertical & Bi-Parting Freezer / Cooler Doors
- ✓ Automatic Sliding Glass Doors
- ✓ Bug Screen Products (Dock Doors / Ramp Doors)
- ✓ Bi-Folding Impact Traffic Doors
- ✓ Safety Rails, Pipe Bollards, Door Track Protectors
- ✓ Concrete Work, Dock Pit Construction, New Door Openings –Turn Key Solutions
- ✓ Cost Effective Scheduled Maintenance Programs (Lubrications, Adjustments, Safety Inspections)

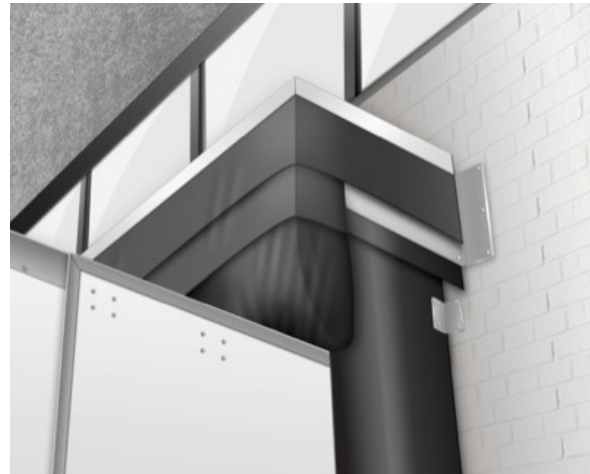

# RAYMOND

## STORAGE CONCEPTS



### DOCK SEALS & SHELTERS

**No drips or cold drafts on operators. No water on trucks. No puddles on dock.**

**Compression style:** Most effective for air penetration and most economical.

**Shelters:** Full width and height access to trailer while eliminating water and air.

**Rain Shield:** Seals the top and can be used with a seal or shelter.



### DOCK LEVELERS

**Proper specification and professional installation are hallmarks of Raymond Storage Concepts**

**Mechanical:** Economic, manual pull chain.

**Air Powered:** Ergonomically safe alternative at an affordable price.

**Hydraulic:** Strength, higher capacity and simple push-button operation.



### VEHICLE RESTRAINTS

**Designed to keep trucks in place during truck loading and unloading**

**Mechanical:** Simplicity of design.

**Electrical:** Electro-mechanical hook design.

**Hydraulic:** Advanced functionality and security for loading dock operations.



### HVLS FANS

**High Volume, Low Speed (HVLS) fans move more air.**

**Powerful:** A breakthrough in electric motor technology.

**Efficient:** 76% more sustained air movement & 50% more efficient when compared to the competition.

**Smart:** Simplifies operation, eliminates maintenance.



### HIGH SPEED DOORS

**From cold storage to high traffic areas**

**Energy Savings:** Custom designed with tight seals against wind, rain and contaminants.

**High Speed Door versus Strip:** Auto open and close has a very quick ROI.

**Soft Bottom Reversible Edge:** Redundant safety systems are virtually incapable of injuring people or equipment.

# Uptime. Every Day.



➤ **Docks and Doors are in constant use.** They need servicing and the best way to do that is with a Scheduled Maintenance Program from Raymond Storage Concepts. This periodic lubrication and adjustment will help you get maximum uptime and life from your investment.

## **Dock Levelers:**

1. Cycle leveler. Add tension to springs based on walk down tension if necessary
2. Inspect Cross Traffic Legs, Cam, Counterbalance, Chain & Hinge
3. Inspect Lip and Rear Hinge Assembly
4. Check lip fall. Insure lip stays extended to reach trailer before falling below dock
5. Check hold down assembly, ratchet bar & pawl
6. Check complete operation of leveler
7. Sweep all debris out of pit and remove from site
8. Check for broken welds on deck and lip structure, rear angle welds, shims, and subframe
9. Check to make sure brush weather seals are in place and a minimal amount of light is showing
10. Check bumpers to be sure of even wear
11. Complete lubrication of all required parts
12. Inspect any other parts per manufacturers specification

## **Trailer Restraints:**

1. Remove debris around restraint
2. Insure inside & outside light packages are properly functioning
3. Inspect light bulbs and lenses
4. Check full operation of restraint
5. Lubricate limit switch mounting brackets
6. Check concrete anchors
7. Check limits and adjust if necessary
8. Inspect any other parts per manufacturers specifications

## **Sectional Doors:**

1. Cycle door. Insure door does not drift down
2. Add or relieve tension depending on door being "hot" or "heavy"
3. Check cables for fraying
4. Check tracks for damage
5. Inspect section condition for damage
6. Inspect drums, fasteners, hinges, and brackets for damage
7. Inspect slide locks
8. Make sure all rollers are in track. Adjust and replace if necessary
9. Lube springs, track, rollers, bearings
10. Check side and top seals for weather tight fit or if missing
11. Check and adjust operators, if present

## **Fire Doors:**

1. Inspect side guides, curtain and end locks, bottom bar, hood and operating mechanism
2. Insure door's operating mechanism, fuse links and release chains/ cables are not painted, coated with dust or grease, and/or covered with debris
3. Operate door. Inspect for any indication of damaged components
4. Perform an annual drop test of all fire door automatic closing features
5. Document the test with all appropriate forms

## **HVLS Fans:**

1. Clean fan blades and motor housing
2. Check support cables / wires
3. Check gear oil

**RAYMOND**  
**STORAGE CONCEPTS**

### **Headquarters**

5480 Creek Road  
Cincinnati, OH 45242  
Phone: 513.891.7290  
Fax: 513.891.7299

### **Louisville, KY**

11921 Carrier Court  
Louisville, KY 40299  
502.491.2237

### **Columbus, OH**

4333 Directors Blvd.  
Groveport, OH 43125  
614.275.3494

### **Lexington, KY**

859.232.8914

### **Dayton, OH**

937.222.0038

[www.raymondsci.com](http://www.raymondsci.com)